

GC50WPC CRUISING WAVE-PIERCER

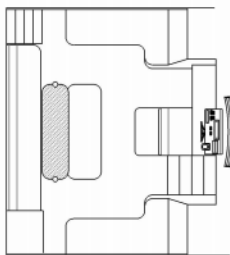
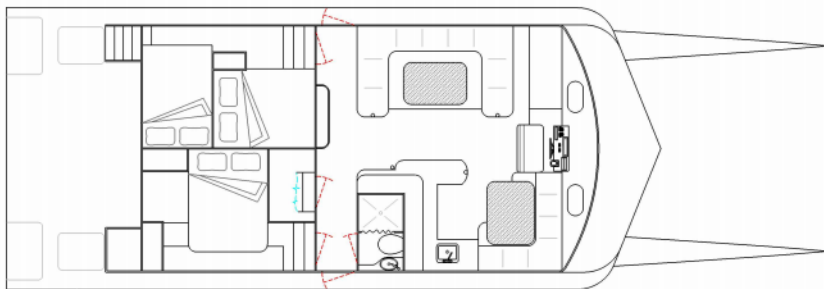
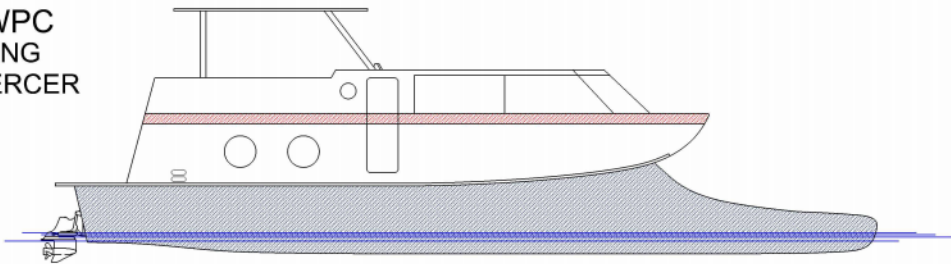

SPECIFICATIONS

LOA	52'
BOA	17'-10"
Draft	1'-10"
Lightship	13,500 lbs
Full Load	18,500 lbs
Engines	190hp I/O x2
Fuel Capacity	200gal.
Cruise Speed	20knots
Top Speed	28knots
Fuel Burn @ Cruise	10gal./hr