

GC65SRI

Luxury Day Sailer

SPECIFICATIONS

LOA	65'
BOA	30'-6"
Draft	3'-10"
Lightship	34,000 lbs
Full Load	54,000 lbs
Passengers	100
Engines	230hp x2
Fuel Capacity	500gal.
Cruise Speed	15knots
Top Speed	18knots
Sail Area	1560ft ²

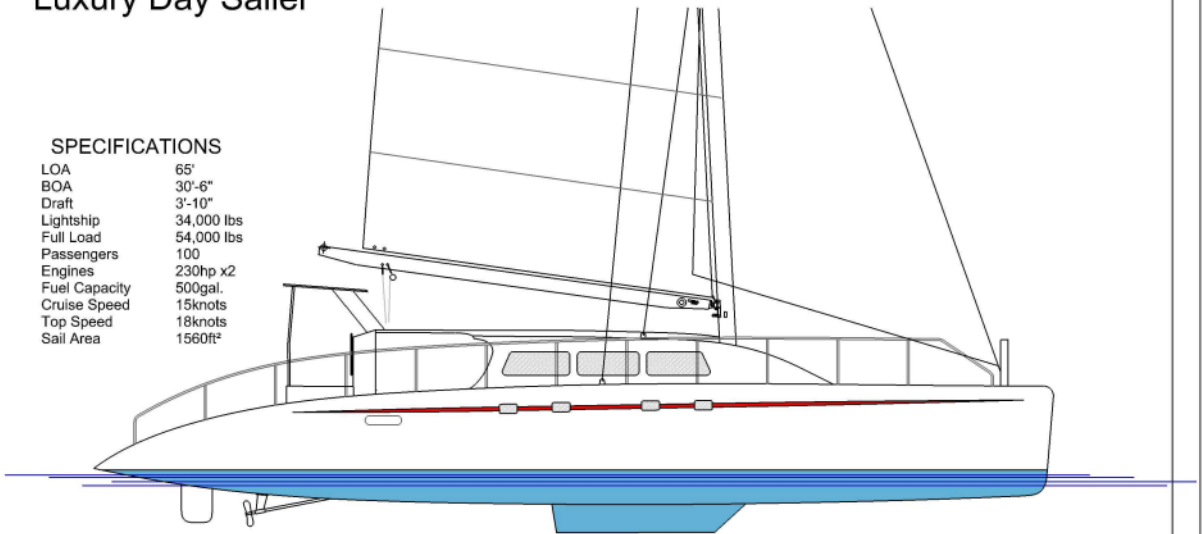

Hull Plan

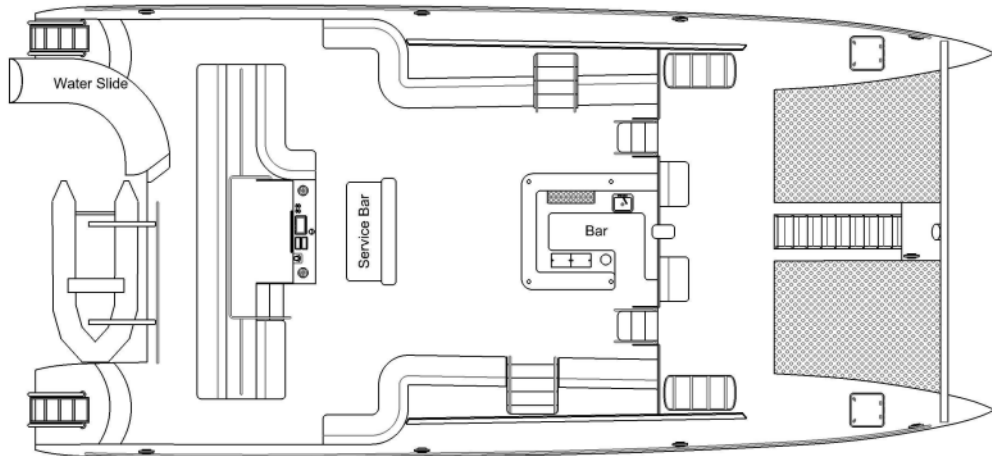
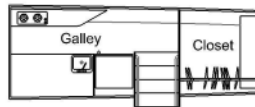

Hull Plan