

GC65P

Guest Shuttle
Profile

SPECIFICATIONS

LOA	65'
BOA	22'-6"
Draft	2'
Lightship	34,000 lbs
Full Load	48,000 lbs
Passengers	55
Engines	380hp x2
Fuel Capacity	150gal. x2
Water Capacity	55gal. x2
Waste Capacity	35gal. x2
Cruise Speed	26knots
Top Speed	29knots



GC65P

Guest Shuttle

Plan

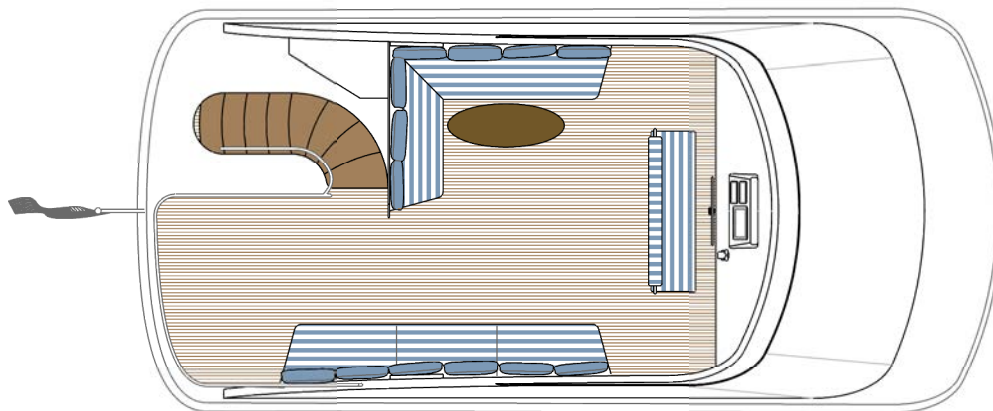
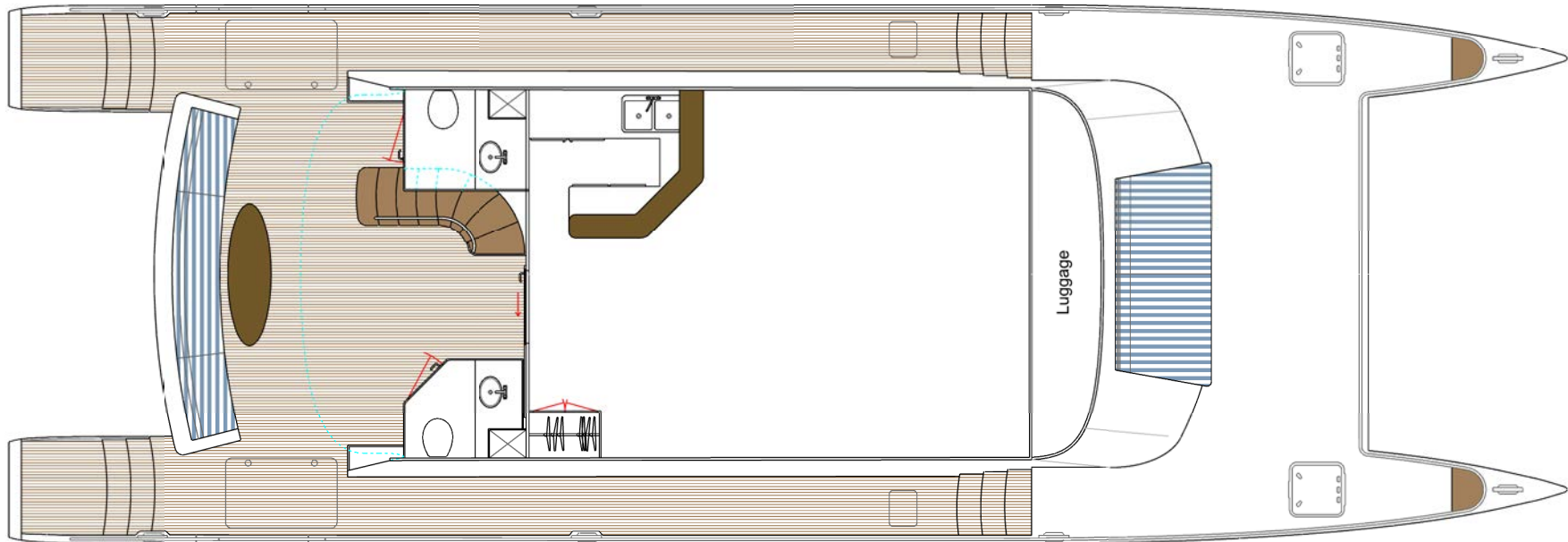

SPECIFICATIONS

LOA	65'
BOA	22'-6"
Draft	2'
Lightship	34,000 lbs
Full Load	48,000 lbs
Passengers	55
Engines	380hp x2
Fuel Capacity	150gal. x2
Water Capacity	55gal. x2
Waste Capacity	35gal. x2
Cruise Speed	26knots
Top Speed	29knots